

**THE
DISTANCE
BETWEEN
EXHIBITION
GUIDE**

THE DISTANCE BETWEEN

FEATURING

**LEROY BACH
CECIL MCDONALD, JR.
TOMEKA REID
CAULEEN SMITH
AVERY R. YOUNG**

EXHIBITION

August 27–September 29, 2013

ARTISTS' RECEPTION AND PARK CROSSING

Sunday, September 15, 2013 3–6pm

CURATORS

Allison Glenn
Monika Szewczyk

ARTS INCUBATOR

301 E. Garfield Blvd.
Chicago, IL 60637

Mon, Wed, Fri, 12pm–3pm
And by appointment
arts.uchicago.edu/artsandpubliclife

LOGAN CENTER FOR THE ARTS

915 E. 60th Street
Chicago, IL 60637

Tues–Sat, 9am–8pm
Sun, 11am–8pm
arts.uchicago.edu/logan/gallery

TABLE OF CONTENTS

5

CURATORS' INTRODUCTION

6

GALLERY ENCOUNTERS

Wednesdays at 6pm

7

ARTISTS' RECEPTION AND PARK CROSSING

Sunday, September 15, 2013 3-6pm

8—9

ARTS INCUBATOR

Exhibition Checklist

10—11

THE DISTANCE BETWEEN

Map with Exhibition Spaces

12—13

LOGAN CENTER FOR THE ARTS

Exhibition Checklist

14

LEROY BACH

15

CECIL MCDONALD, JR.

16

TOMEKA REID

17

CAULEEN SMITH

18

AVERY R. YOUNG

19

ACKNOWLEDGEMENTS

CURATORS' INTRODUCTION

The Distance Between is a culminating exhibition showcasing the work of the five Arts + Public Life/Center for the Study of Race, Politics & Culture 2012/2013 artists-in-residence. The program awards ten-month residencies to outstanding Chicago-based artists who have an expanded social practice that engages issues of race, politics and culture. Their physical studios are at the Arts Incubator in Washington Park at 301 E Garfield Boulevard, and they have access to University of Chicago resources, such as the production facilities of the Reva and David Logan Center for the Arts at 915 East 60th Street.

Looking at a map of the South Side these days, one might notice these two new cultural venues lying in close proximity. They are a mere six-minute drive, or two Green Line stops apart. Between them stretches the southern half of Washington Park, which can be crossed by foot in a number of ways in less than half an hour. Yet the day-to-day experience of these artists (and the curators working with them) is that the distance between these two sites of artistic activity is not so simply defined.

The Western edge of Washington Park (at the Garfield stop of the Green Line, directly opposite of the Arts Incubator) and the Southwestern edge of the University of Chicago campus (which is home to the Logan Center) may be close on the map; but in terms of demographics and urban texture they are often seen as worlds apart. Indeed many people residing or working in the vicinity of one of the two institutions may have never made the short trip to see the other building. The park stretching between the two spaces is, to many, a realm of leisure and pleasure, yet to many others, a no-go zone. Between these two extremes a myriad of spatial possibilities are often overlooked.

The artists who have spent the last ten months in residence include visual artists (Cecil McDonald Jr. and Caileen Smith), musicians (LeRoy Bach and Tomeka Reid) and the multidisciplinary poet, artist and educator avery r. young. They have made it their daily practice to move between their two production spaces and to explore the surrounding areas—listening to the street and the diverse flora and fauna of Washington Park; collaborating with neighbors; depicting their surroundings; and envisioning alternative value systems.

This two-venue exhibition marks a culmination of their efforts, with works installed so as to invite visitors to linger, look and listen at each exhibition site; but also to travel the distance between the two venues. These works include a range of pictorial approaches, listening stations, space stations, assemblages, collaborations, and several improvised performances—creating an ambiance that willfully bends the demographic charts and finds luxury where loss and paranoia persist.

At stake here is the very perception of space—urban, pastoral, domestic, social and artistic—as both a physical phenomena and a psychological construct.

While these artists do not shy away from the fraught questions of race and class, which impact the perceptions of this particular segment of the map (and, it may be argued, the broader stretches of Chicago's South Side and areas like it around the country or even around the world)—far from it—they ultimately aim to invent new terms of engagement.

Allison Glenn & Monika Szewczyk

Join the artists in conversation about their work. Gallery Encounters are conceived to provide context for each artist's contribution to the exhibition and serve as an occasion to reflect more broadly on their practice and on their experience in the residency.

CECIL MCDONALD, JR.

Wednesday, August 28, 6pm

Arts Incubator

TOMEKA REID

Wednesday, September 4, 6pm

Logan Center Gallery

CAULEEN SMITH

Wednesday, September 11, 6pm

Arts Incubator

LEROY BACH

Wednesday, September 18, 6pm

Arts Incubator

AVERY R. YOUNG

September 25, 6pm

Logan Center Gallery

SCHEDULE

3 - 3:30PM

LOGAN CENTER FOR THE ARTS

A Summer's Guitar Sextet

Featuring LeRoy Bach, Matthew Clark,

Gillian Lisee, Bill MacKay, John Preus, Sam Wagster

3:45 - 4:15 PM

ARTS INCUBATOR & LOGAN CENTER FOR THE ARTS

Washington Park Suite (Set 1)

Cello: Fred Lonberg-Holm and Tomeka Reid

Live Sound Manipulators: Todd Carter and Alex Ingilizian

4:15 - 5:15 PM

WASHINGTON PARK CROSSING

buses available, walking and biking encouraged

5 - 5:30 PM

ARTS INCUBATOR & LOGAN CENTER FOR THE ARTS

Washington Park Suite (Set 2)

Cello: Fred Lonberg-Holm and Tomeka Reid

Live Sound Manipulators: Todd Carter and Alex Ingilizian

5:30-6PM

ARTS INCUBATOR

Live music featuring LeRoy Bach, Malyk Singleton, Mikel Avery

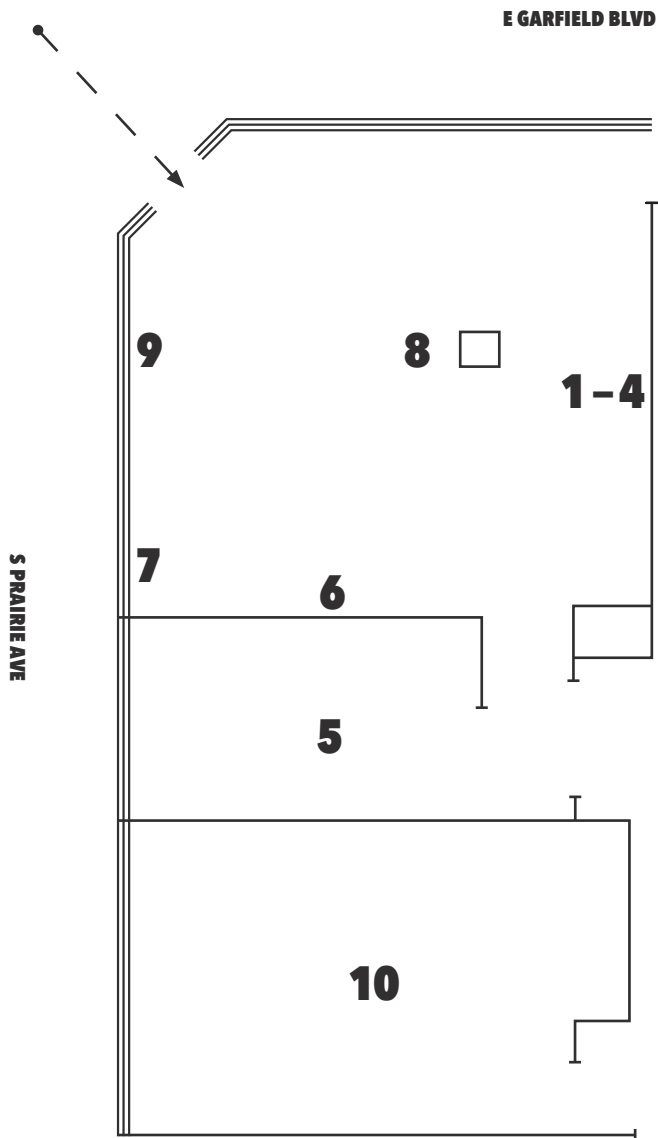

- 1 - 4 CECIL MCDONALD, JR.**
Selections from the series *Domestic Observations and Occurrences*, 2013
Archival pigment prints
- Too Be Cool*
Panther Baby
Baby Boy
Spectate Space
- 5 CECIL MCDONALD, JR.**
Nice and Slow, 2012
DVD for projection
- 6 AVERY R. YOUNG**
30.30.13: lady sing(s) de blue(s) or billie head was bleevin at Carnegie hall, 2013
Wood, paper, plastic, tape, granite, mustard, glue, paint, ink
- 7 LEROY BACH**
Selections from the album *Tim Kinsella Sings Songs of Marvin Tate*
by *LeRoy Bach Featuring Angel Olsen*, 2013
Sound
- 8 AVERY R. YOUNG AND NORMAN TEAGUE**
fi a teddy bear; i want my baby back blk!, 2013
Wood, ink, paint, glass, tape, glue
- 9 CECIL MCDONALD, JR.**
Black Bottom Boulevard, 2013 (ongoing)
Photo-montage for projection
- 10 CAULEEN SMITH**
Raven-Disciple Space Station, 2013
Too many found and new materials to ever list in a guide

GROUPED WORKS ARE LISTED LEFT TO RIGHT.

THE DISTANCE BETWEEN

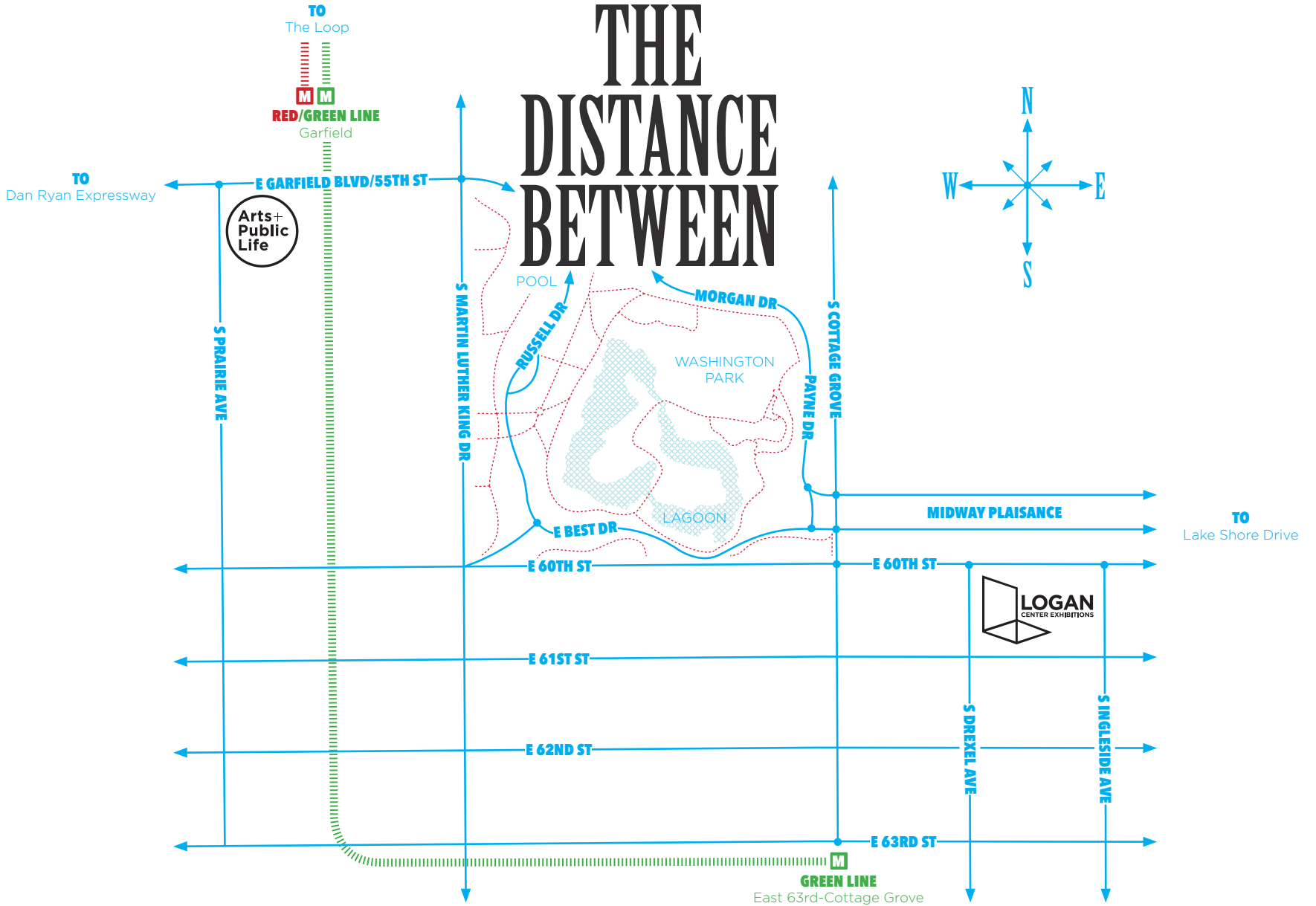

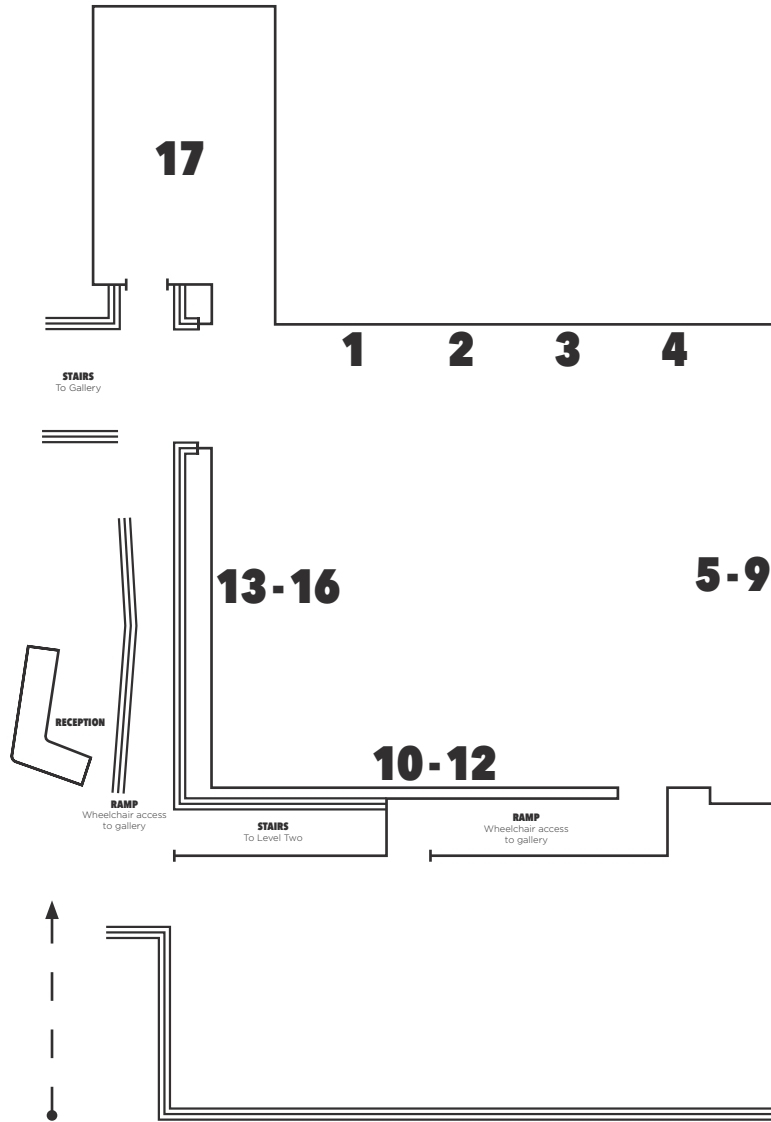

E 60TH ST

- 1 AVERY R. YOUNG**
(blk)kestra, 2013
Tar, vinyl, paper, ink, acrylic paint, metal, sandpaper
- 2** *dat new blk!*, 2013
Wood, paper, ink
- 3 LEROY BACH**
Selections from the album *Tim Kinsella Sings Songs of Marvin Tate by LeRoy Bach Featuring Angel Olsen*, 2013
Sound
- 4 AVERY R. YOUNG**
de holyghos(t) n'em, 2013
Tar, vinyl, Plexiglas, paper, ink, acrylic paint, metal, sandpaper
- 5-9 CECIL MCDONALD, JR.**
Selections from *Nice and Slow*, 2013
Archival pigment prints

One Black Eye
Dusky Record
Spinning While Black
Blue Magic
So ... Is Black Beautiful?
- 10-12 CECIL MCDONALD, JR.**
Selections from the series *Domestic Observations and Occurrences*, 2013
Archival pigment prints

Light Skin Soul
Color Line
Catch and Release
- 13 AVERY R. YOUNG AND CECIL MCDONALD, JR.**
de melon eaters (cover of booker t. soltreyne: a race rekkid), 2013
Archival pigment print
- 14 AVERY R. YOUNG**
set list, 2013
Wood, paper, ink, acrylic paint, metal
- 15** *what booker t. told lomag*, 2013
Tar, vinyl, Plexiglas, paper, shoe polish, paint, metal, sandpaper
- 16 AVERY R. YOUNG / A.B. BLK & ASSOCIATE(S)**
choir rehearsal, 2013
Sound | 53 min.
- 17 CAULEEN SMITH**
Monk-Ranger Space Station, 2013
Screen print on wallpaper, carpet, disco balls, video, sound

GROUPED WORKS ARE LISTED LEFT TO RIGHT.

Musician and composer LeRoy Bach has fostered musical collaborations and musical gatherings in Chicago for over twenty-five years, such as the monthly gathering that he leads, Low Tide Dance. He maintains collaborations with poet Marvin Tate, musicians Bill MacKay and Tim Kinsella, as well as fellow APL/CSRPC artist-in-residence avery r. young. For the past five years Bach has performed with Theaster Gates and The Black Monks of Mississippi. He has also worked with Rob Mazurek, Wilco, and 5ive Style, among others.

Bach is a former resident at the Headlands Center for the Arts. He has scored live musical accompaniments for film documents presented by the Chicago Film Archives.

Through photography, video, and text, Cecil McDonald, Jr. explores the intersections of masculinity, familial relations, and the artistic and intellectual pursuits of black culture. McDonald studied fashion, house music, and dance club culture before receiving a MFA in Photography at Columbia College Chicago, where he currently serves as an adjunct professor and a teaching artist via the Center for Community Arts Partnership. His work has been exhibited both nationally and internationally, with works in the permanent collection of The Cleveland Museum of Art, Chicago Bank of America LaSalle Collection, and the Harris Bank Collection. He has been honored with the Joyce Foundation Midwest Voices & Visions Award; the Artadia Award; The Swiss Benevolent Society Residency in Lucerne, Switzerland; and the 3Arts Teaching Artist Award.

McDonald, Jr.'s recent projects include Looking for Baldwin: A Stranger in the Village, and I Can't Turnaround: Where do we go from Here?—a teaching artist residency using photography and text to explore questions and affects of intensive intervention initiatives in underachieving Chicago Public Schools commonly referred to as School Turnaround.

Tomeka Reid is a Chicago-based cellist, composer, and educator. Reid has led string improvisation workshops in Italy and the US, and co-directed the string program at the University of Chicago's Laboratory School from 2005 to 2011. As part of her 2012/13 Arts + Public Life/Center for the Study of Race, Politics & Culture artist residency, she founded the Chicago Jazz String Summit. Most recently she directed the 2013 Vancouver Jazz Festival's High School Jazz Intensive.

Recent commissions include compositions for the Association for the Advancement of Creative Musicians and the Chicago Jazz Ensemble with performances at the Chicago Jazz Festival as well as opportunities abroad at festivals such as Umbria Jazz, An Insolent Noise, and Vignola Jazz. Previous residencies include the Ragdale Foundation and the 2nd Annual Make Jazz Fellowship hosted by the 18th Street Arts Organization. She was selected as a 2012 participant in the Jazz Composers Orchestra Institute held at the University of California Los Angeles. Reid is also a doctoral candidate at the University of Illinois at Urbana-Champaign.

For the past several years Cauleen Smith has produced multi-channel film and video installations, as well as live events that incorporate sculptural objects, music and text. Her interests roam from her roots in structuralist filmmaking to afro-futurist narrative strategies. In 2012 Cauleen Smith was named Outstanding Artist by the National Alliance for Media Arts and Culture. She has received grants from the Film Arts Foundation American Film Institute, Rockefeller Foundation, and Creative Capital. Her films and installations have shown at The Kitchen, Yerba Buena Center for the Arts, Los Angeles County Museum of Art, the Museum of Contemporary Art in Los Angeles, Nelson Atkins Museum of Art as well as in film festivals in Los Angeles, Milan, Park City, London, New York, Lagos, Paris, Oakland, Berlin, and Austin. Cauleen Smith received her B.A. from the School of Creative Arts at San Francisco State University and her M.F.A. from UCLA School of Theater-Television-Film.

Blending phonetics, linguistics, hymns, jazz, and hip-hop, avery r. young explores the politics and attributes of the African-American experience. young's work, which he calls "sunday mornin jook joint," merges spiritual and secular aesthetics with dramatic and comedic sensibilities.

A Cave Canem Fellow, young has worked as a teaching artist, mentoring youth in creative writing and theater. He has written curriculum for Columbia College Chicago, Young Leeds Authors, True Star magazine, and Chicago Public Schools' Art Integration Department. young's essays on HIV awareness, misogyny and sexism in arts and media, educational reform, and workplace-art integration have been published in AIMPrint, The Teaching Artist Journal, and swaggerzine. young's written work also appears in such anthologies as Callallou, To Be Left With The Body, Warpland, Coon Bidness, Reverie Review, War Diaries, Make Magazine, The Spaces Between Us, and Fingernails Across The Chalkboard.

young has performed in the Hip Hop Theatre Festival, Lollapalooza, and WordStock and is featured on the compilations New World Reveal-A-Solution, Audio Truism, Catfish Haven's Devastator, and New Skool Poetics. young has appeared on BET, MTV, ABC, and WGN's Morning News.

ARTISTS

LeRoy Bach
Cecil McDonald, Jr.
Tomeka Reid
Caulleen Smith
avery r. young

CURATORS

Allison Glenn
Monika Szewczyk

CURATORIAL ASSISTANT

Katherine Harvath

GRAPHIC DESIGN

David Giordano

EXHIBITION SPONSORS

Arts + Public Life
Center for the Study of Race, Politics and Culture
Logan Center Exhibitions/Reva and David Logan Center for the Arts
UChicago Arts

THE CURATORS WISH TO EXTEND A SPECIAL THANKS TO:

Theaster Gates, Dominique Boyd, Harold Brown, Sonia Dhawan, Dara Epison, Emily Hooper Lansana, J. Alan Love, Chet Lubarsky, Valentina Solano, Norman Teague, Mercedes Zavala and all staff, volunteers and interns at Arts + Public Life; Michael C. Dawson, Sean Lee, Tracye Matthews and the staff of the Center for the Study of Race, Politics and Culture; Ben Chandler, Mike Gibisser and David Wolf and their staff at the Logan Media Center; Hannah Givler and her team at the Logan Shop (Ramyar Vala, Chris Eastman, Tucker-Rae Grant, Zoe Karder Nalebuff, Jinn Bronwen Lee, Katie Soule); Bill Michel, Jim Adair, Leigh Fagin, Nicole Foti, Adrian de Gifis, David Giordano, Katherine Harvath, Mitch Marr, Remi Prechelt, Nora Semel, Tara Wood and all the staff, volunteers and interns at the Reva and David Logan Center for the Arts.

ADDITIONAL THANKS TO:

Carla Mayer/Chicago Parks District and the Washington Park Advisory Council; Murray Plotkin/Artisan Handprints Inc., Jim Wardle/Murphy Design Studio, Marcus Warren/The Great Frame Up; Charlie Boyd, Stephen Flemister, Tom Lee, Duane Skrbina.

LAST BUT NOT LEAST:

The 2012/2013 Arts + Public Life/Center for the Study of Race, Politics and Culture Artists-in-Residence.

